

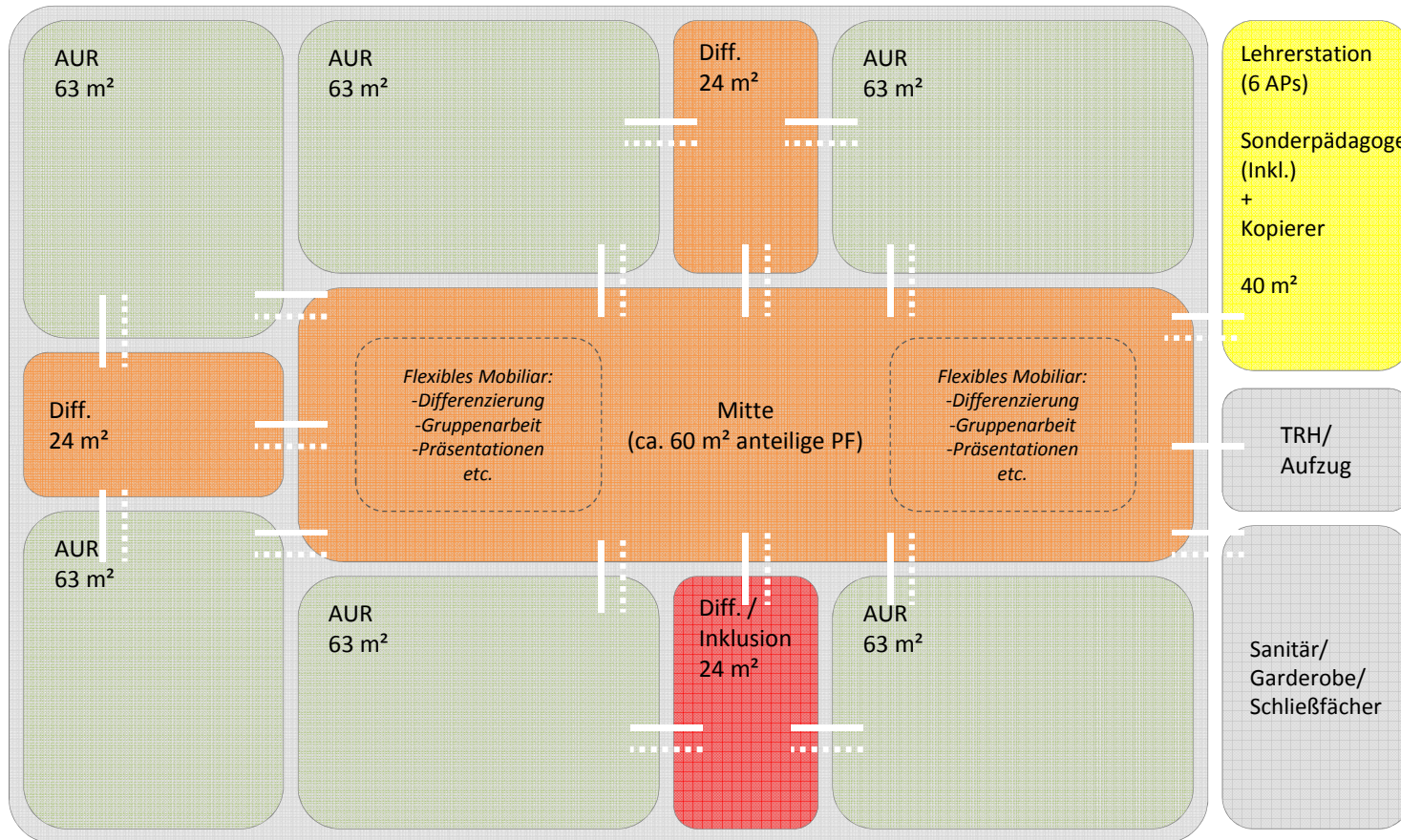

Neues Gymnasium Leibniz
„Campus Feuerbach“
Raum- und Funktionsprogramm



STANDARD-JAHRGANGSCLUSTER:



Cluster:	Programmfläche:	510 m ²
	Lehrerstation:	40 m ²
	Mitte:	187,5 m ²
	- PF	60 m ²
	- VF	127,5 m ²
	Gesamtfläche:	737,5 m²

Die Mitte beinhaltet als VF 25 % der Programmfläche des Clusters.



OBERSTUFENCLUSTER 1:

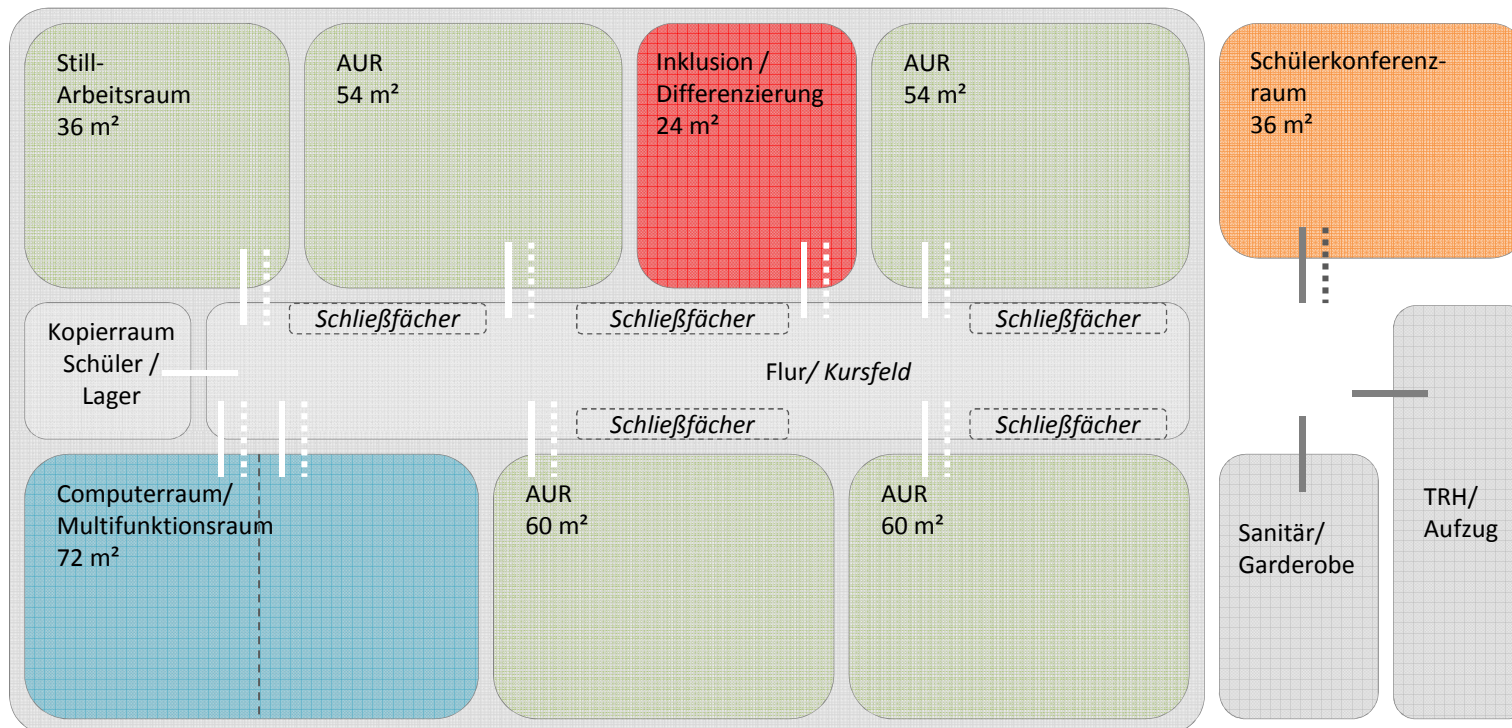



OBERSTUFENCLUSTER 2:

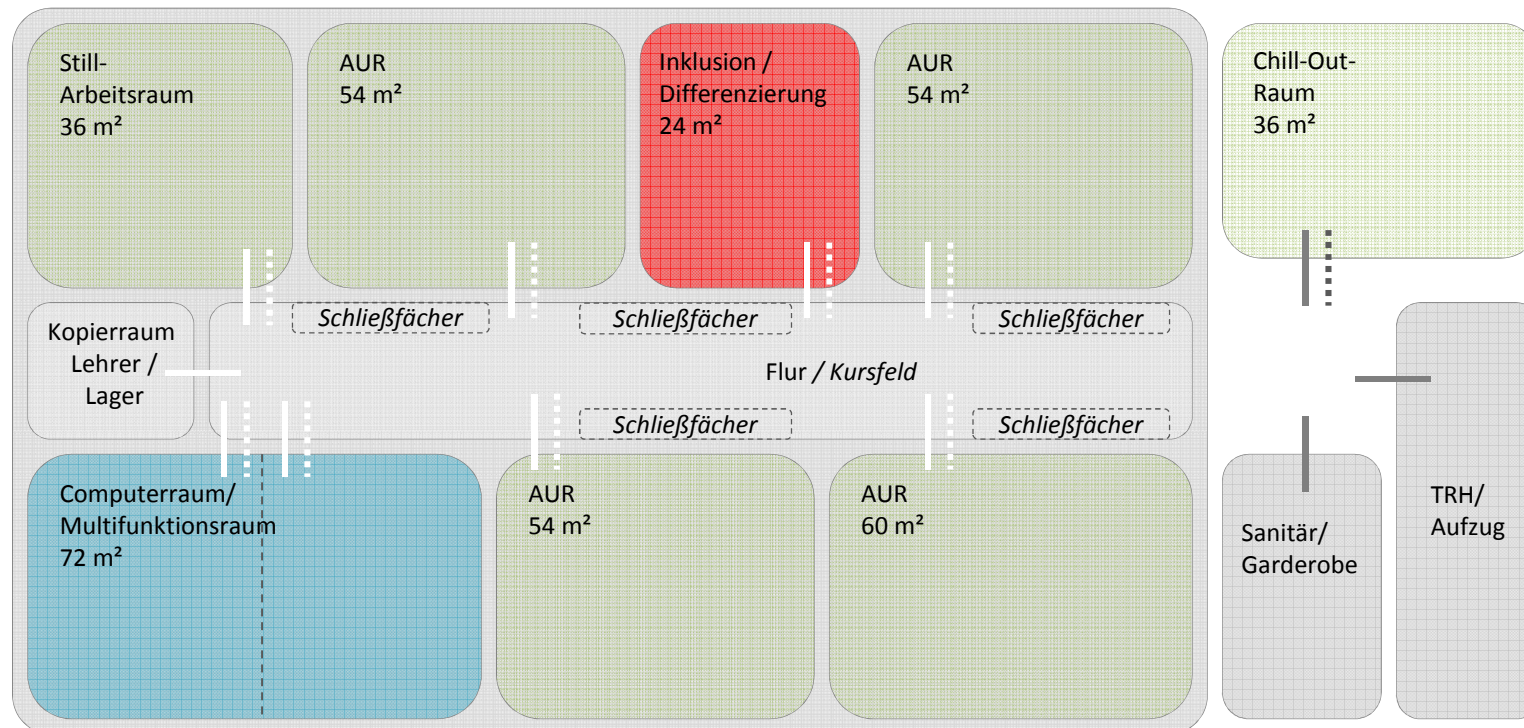

OBERSTUFENCLUSTER 1+2:

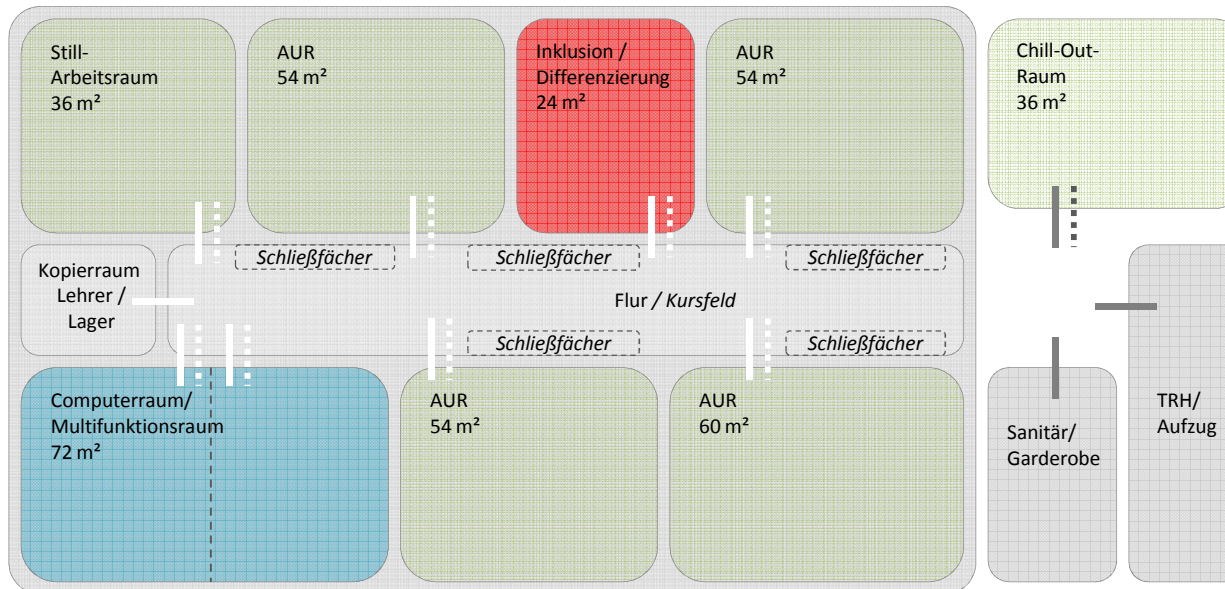
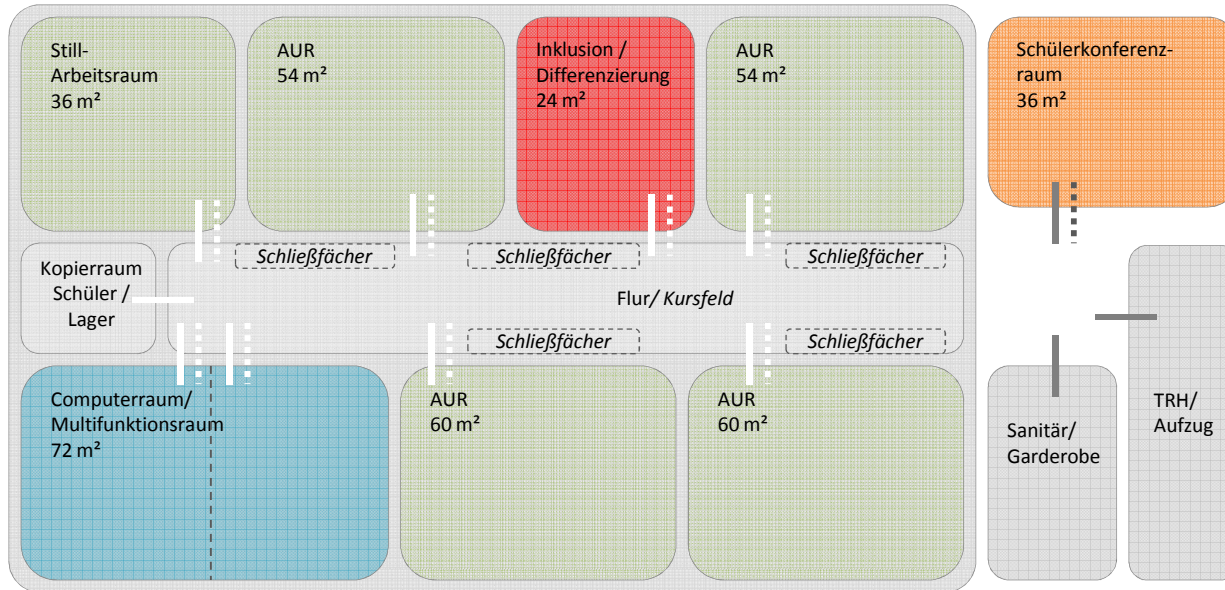



BK+PHYSIK-CLUSTER:

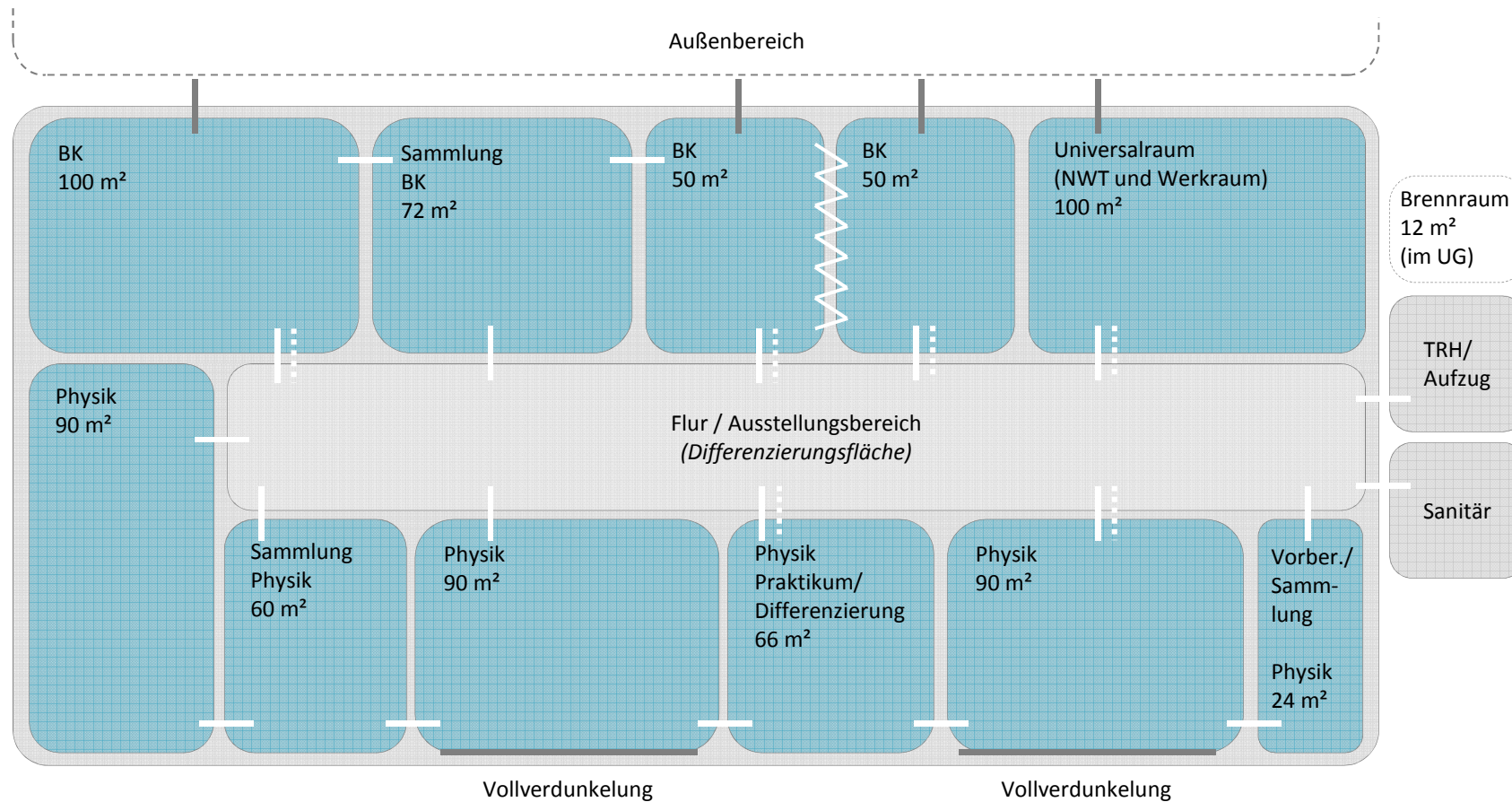



CHEMIE+BIO-CLUSTER:

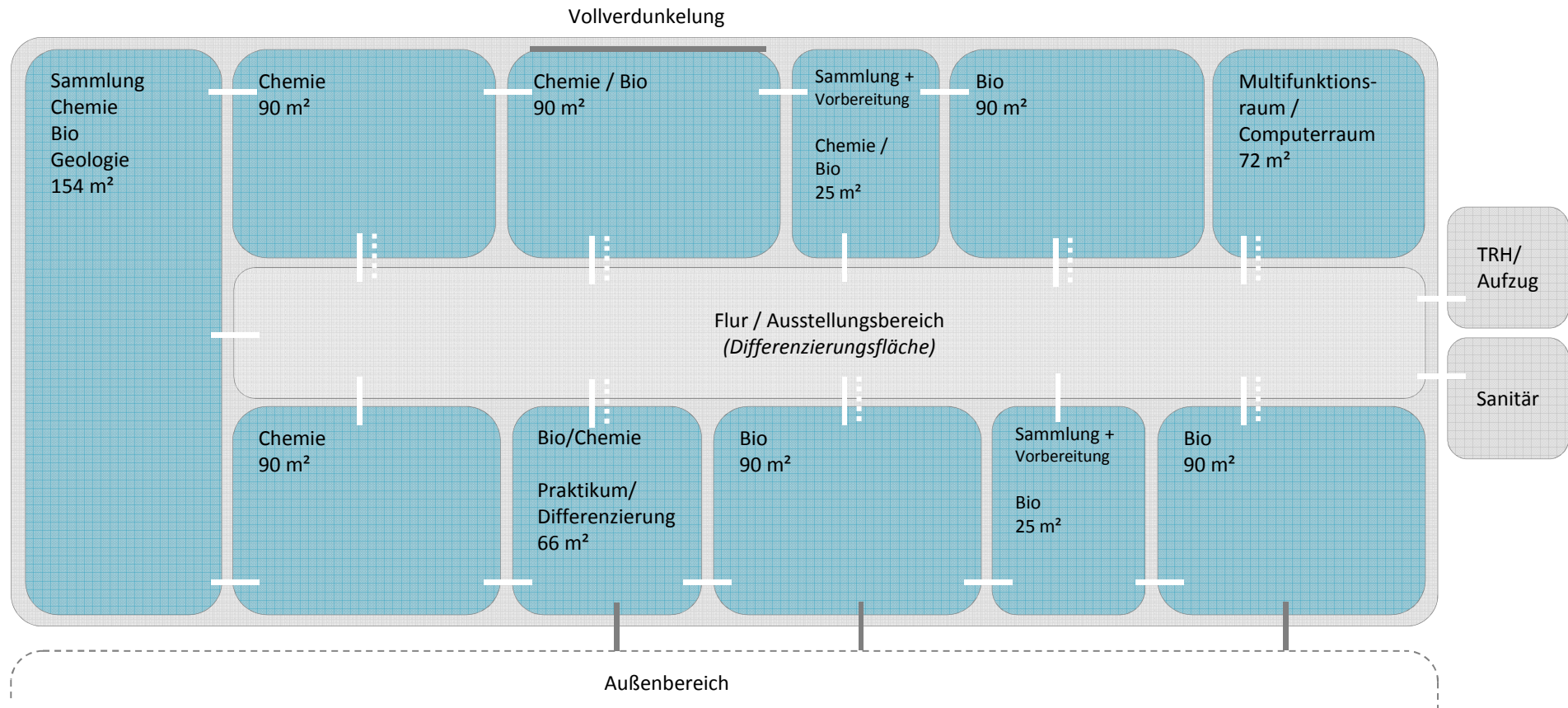

NW CLUSTER:

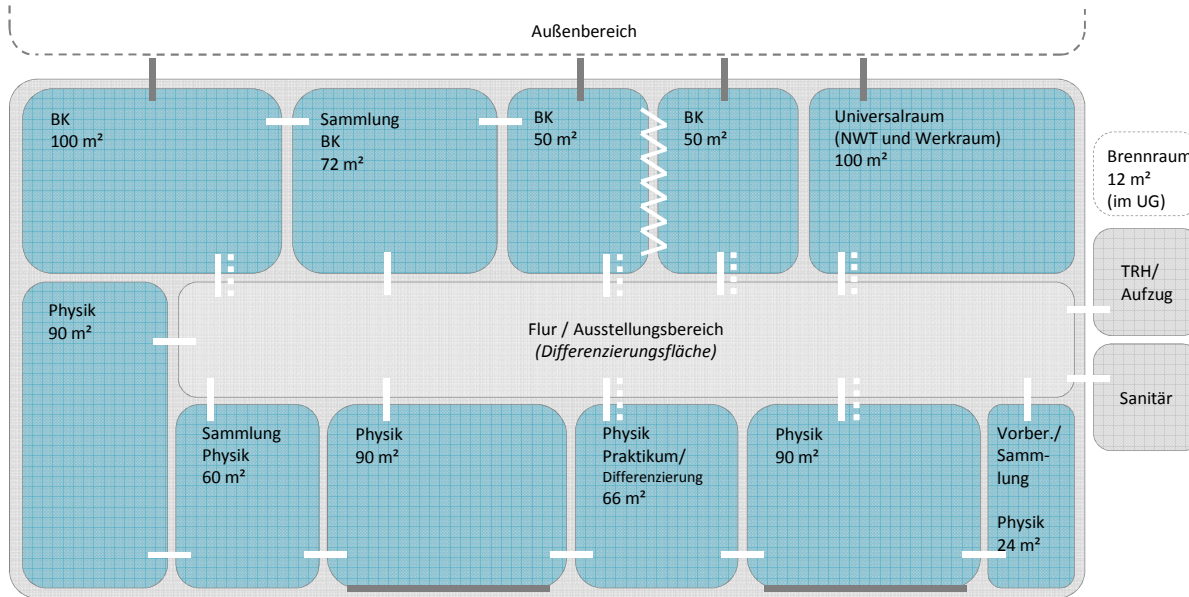

Möglichkeit zur Vollverdunkelung

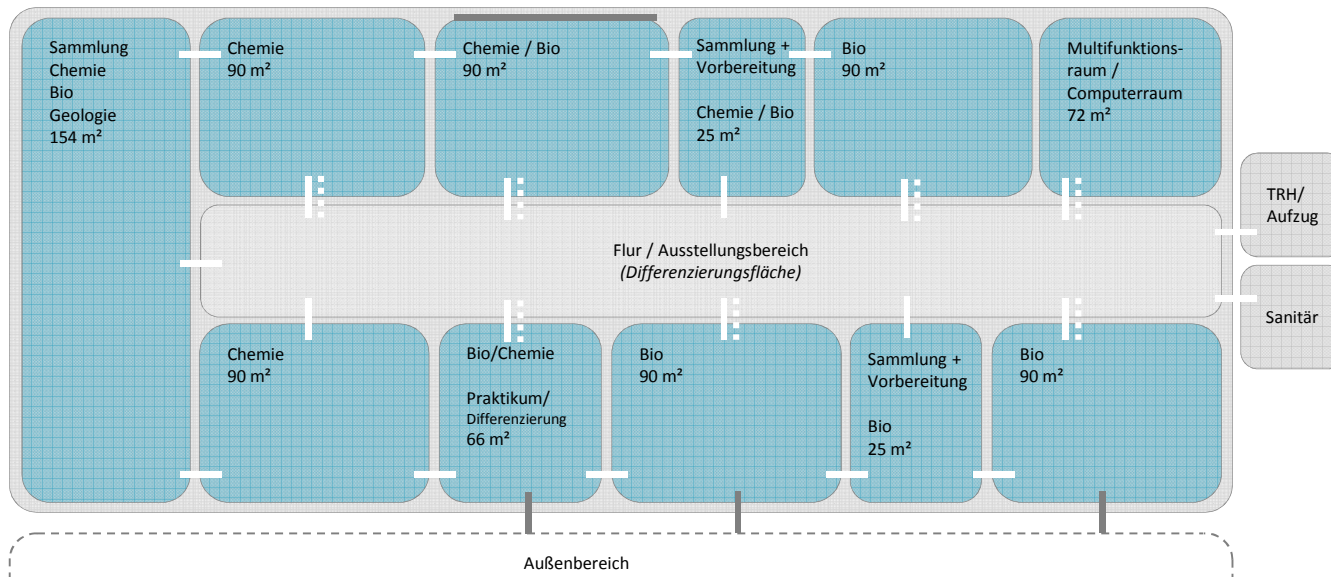

HERZ DER SCHULE UND MUSISCHER BEREICH:

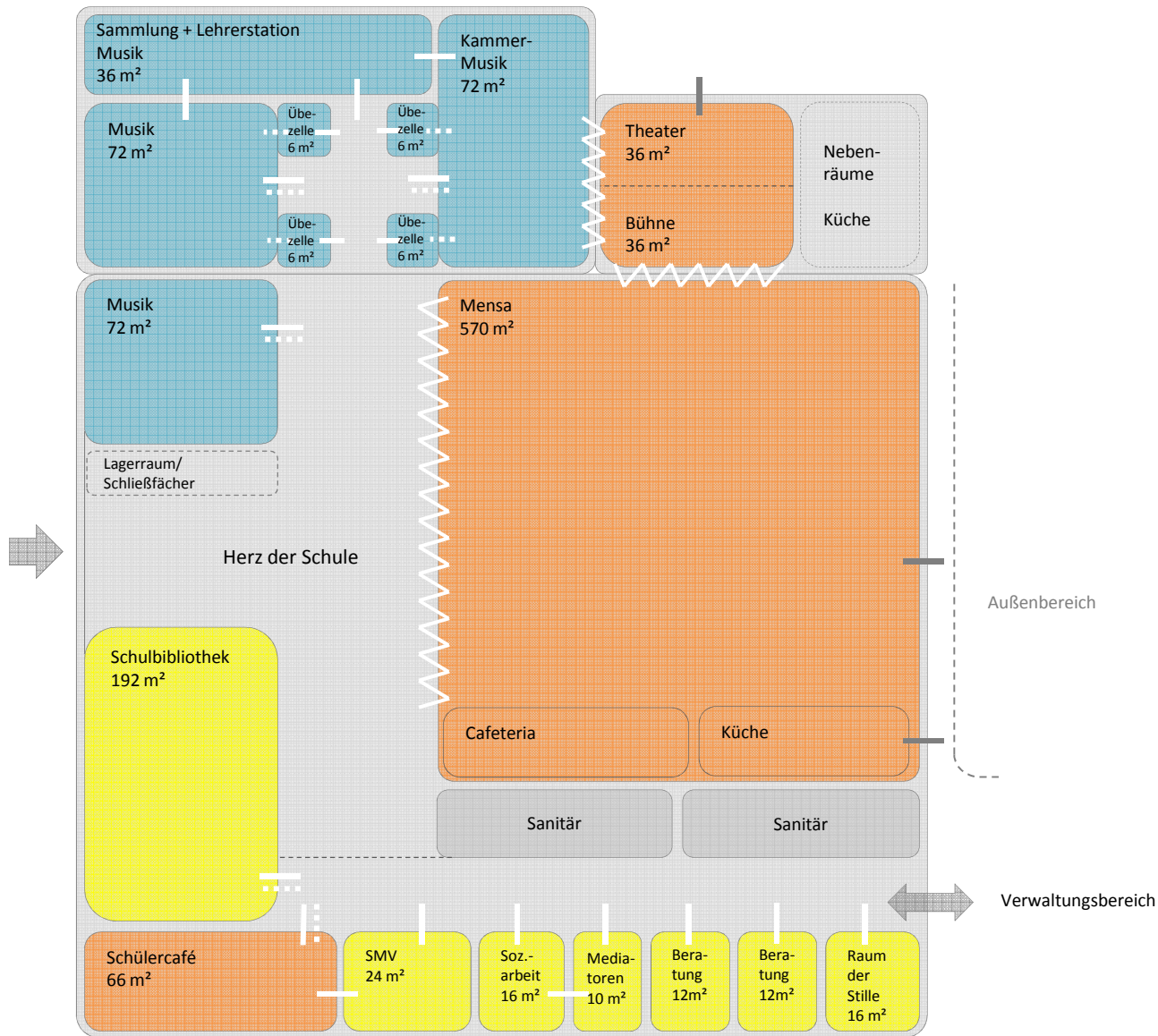

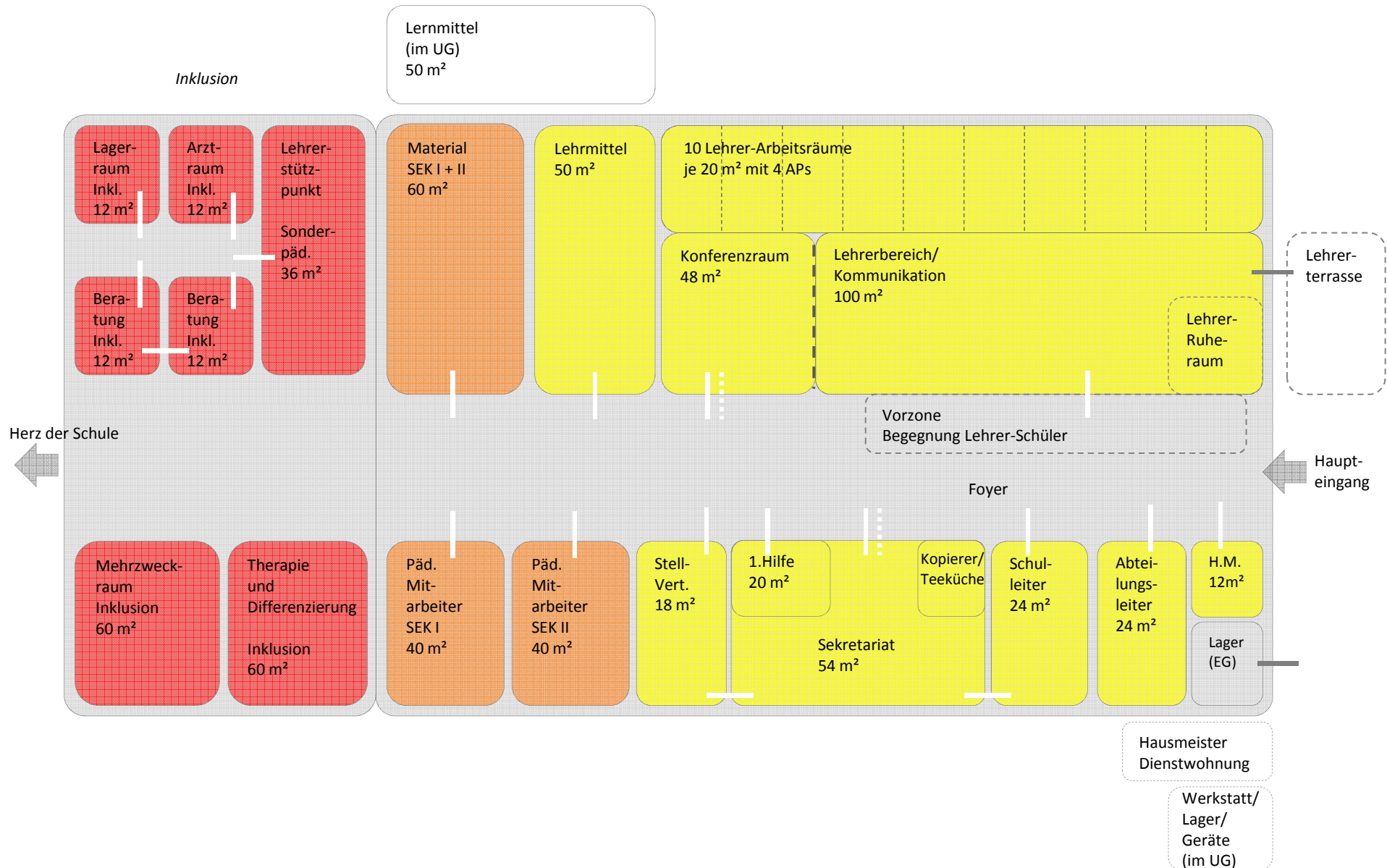

SPORTHALLE:

3-teilbare Sporthalle ca.2074 m² (nach DIN)

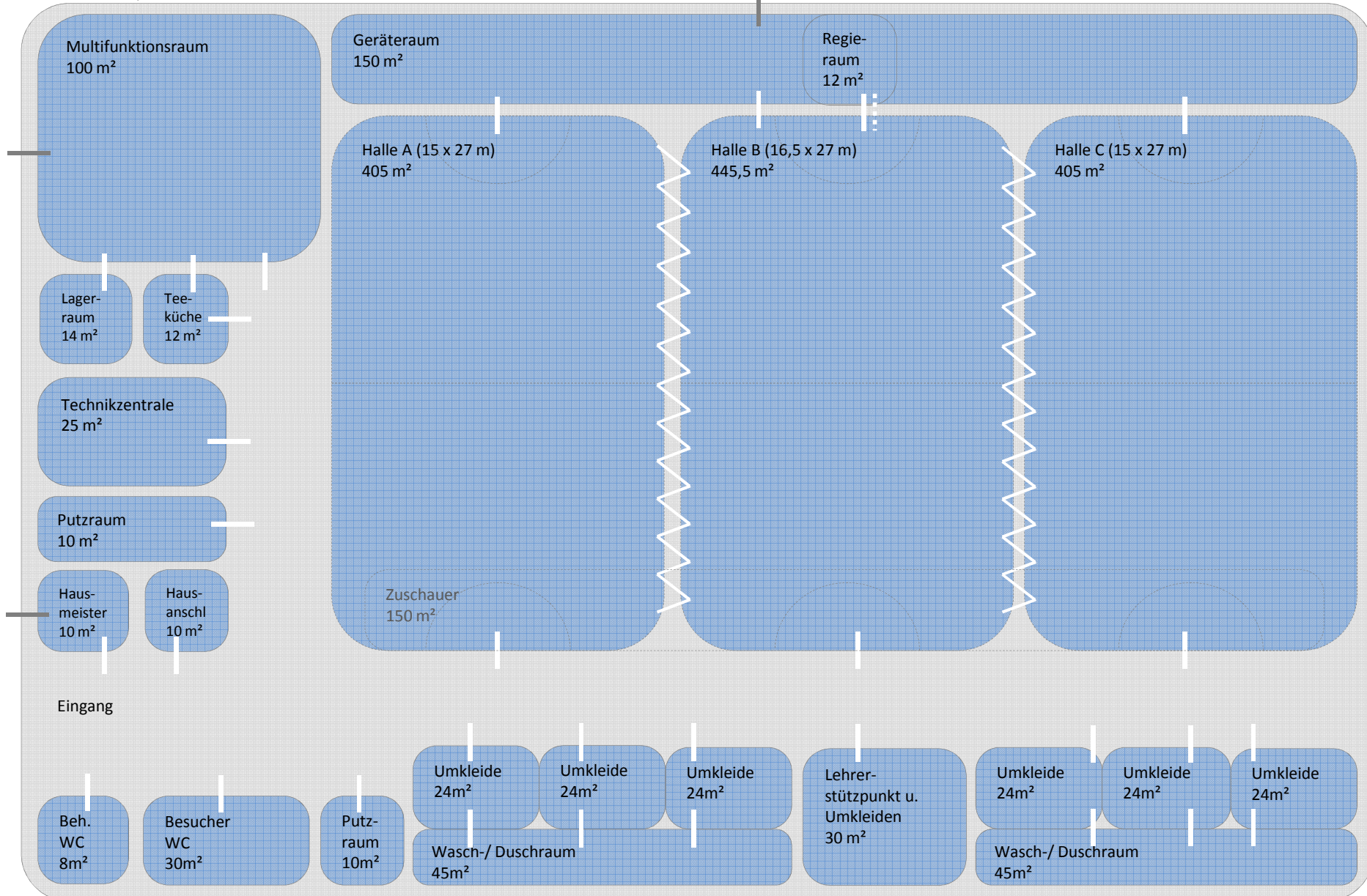

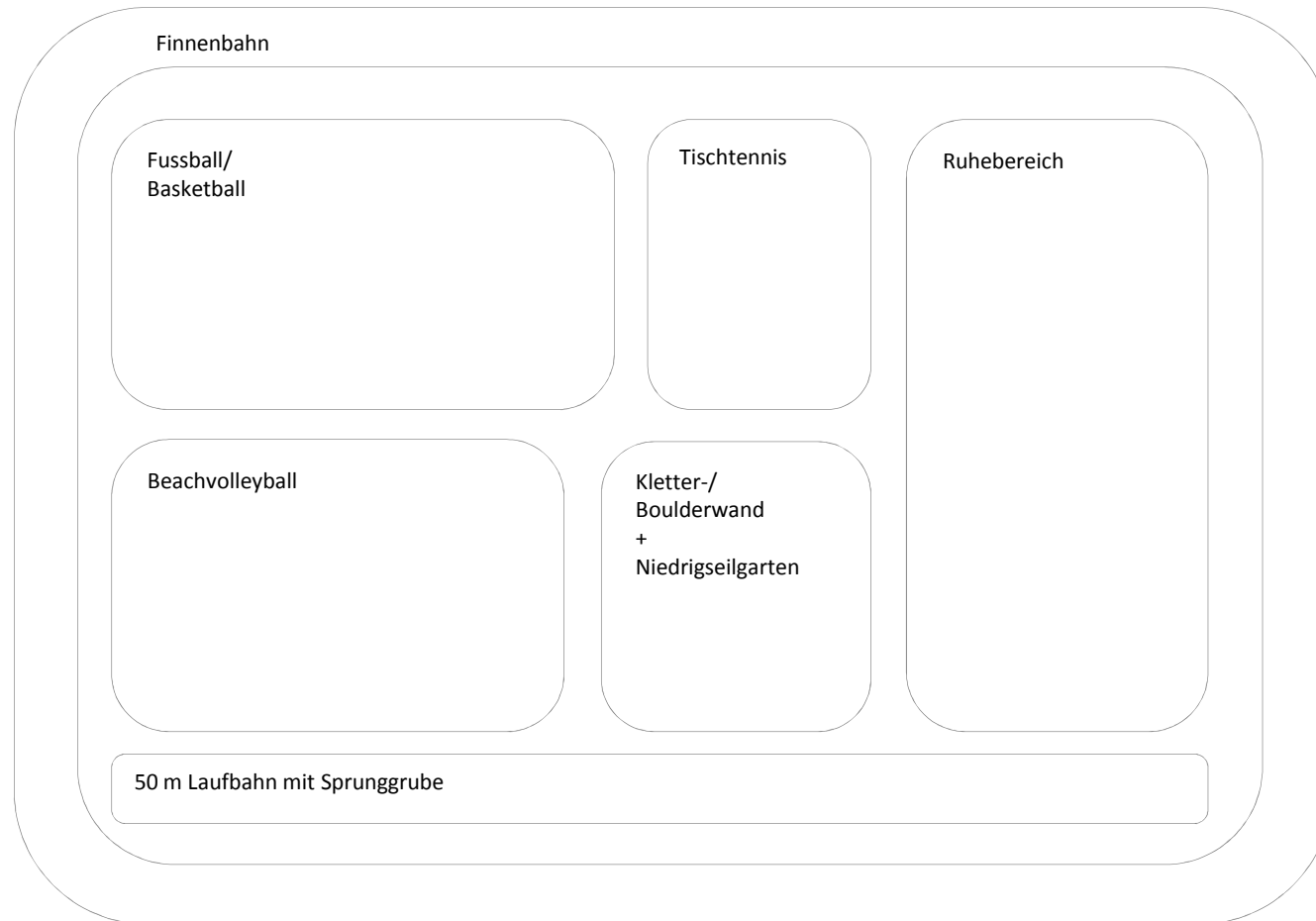



SPORTBEREICH GESAMT:

(Ist bezüglich der Belange des Vereinssports noch mit dem Sportamt abzustimmen)

